

# WALL WASHER LED STRIP

Model: SE120LCG-10



## Features

- 1) Revolutionary wall wash performance, giant improvement from a linear performance.
- 2) Wall wash space 0.5–1 meters.
- 3) Multiple light-emitting angle options: 30°/60°.
- 4) Color options: 2700K/3000K/3500K/4000K/5000K/6500K.
- 5) Quick connection system with solderless accessories provided .
- 6) CE, RoHS, UL, TUV, BIS, CB and LM–80 certified.
- 7) 3 years warranty.

## Application

Up to 1M decorative wall washing, wildly beneficial for lighting designs.

## Parameters

Part Number	SE120LCG–10	CRI	Color	CCT(K)	Beaming Angle	Luminous Flux (LM/M)	Efficacy (LM/W)
Dimensions	5000*10mm		WW	● 2700	30°	800	80
LED Type	2835 LED		WW	● 3000	30°	800	80
LED Qty/m	120LEDs/m	80+	NW	● 4000	30°	850	85
Voltage	DC24V		MW	● 5000	30°	850	85
Input Current (A)	0.42A (1m)		W	● 6500	30°	850	85
Power	10W/M	<b>Remarks:</b>					
Power Range	9~11W	1) The given data are typical values due to the tolerance of the production and electrical components, output value and electrical power can vary up to 10%.					
Times of Power On and Off	>10000 Times	2) Testing standards refer to IES LM–79–08.					
IP Grade	IP20	3) The above luminous flux is based on CRI80, and the number will reduce by around 20% in CRI 90.					

## Dimension

(Unit: mm)

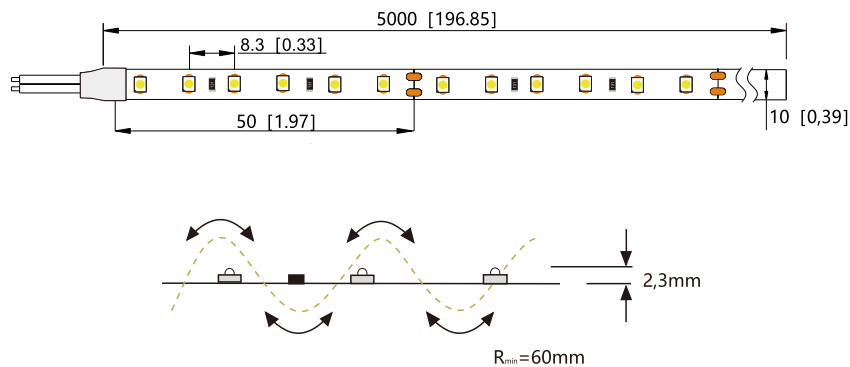

## Rendering Index Comparison

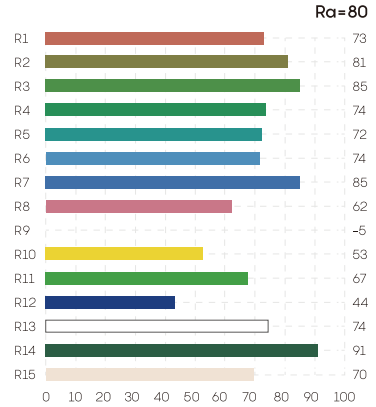
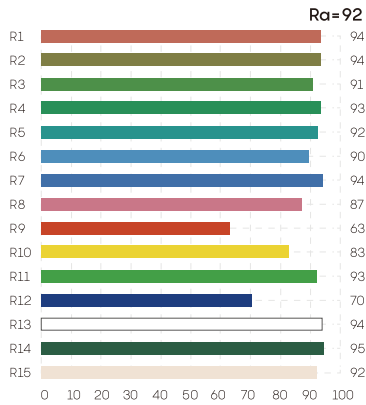

## Provides Different IP Graded Strips

**IP20**

Non-waterproof



LED  
FPC

(indoor)

**IP65**

Hollow neon sleeve waterproof



Silicon glue extrusion  
LED  
FPC

(in humid air)

## Provide Full CCT Range From 2700K to 6500K

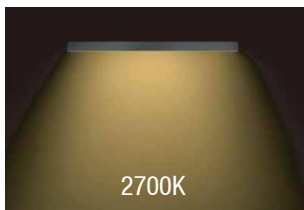

## Beaming Angle

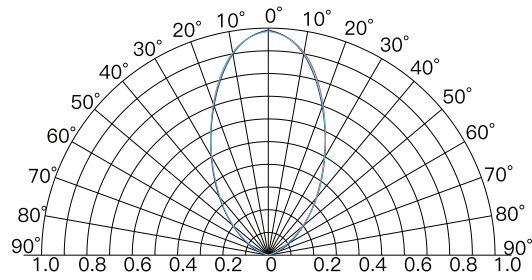

beaming angle 30°

## Wire Connection

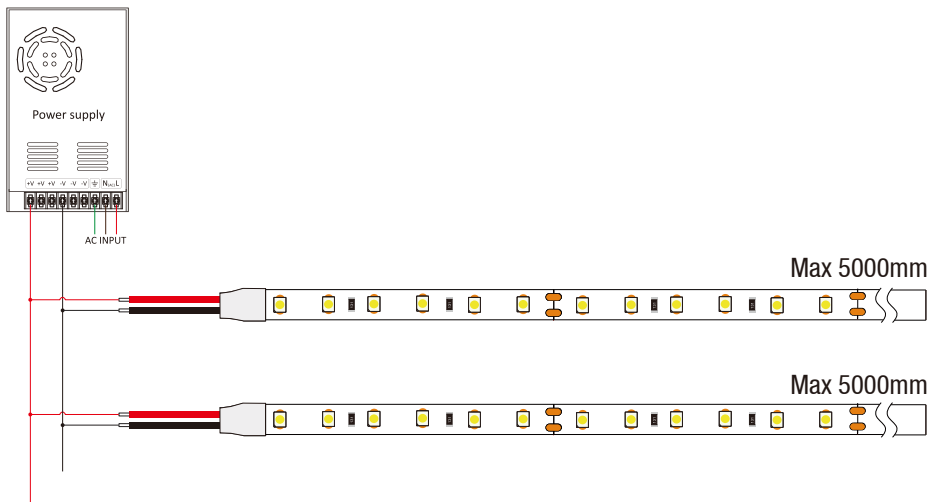

Standard Accessories				Recommended Accessories Profile			
Item	Name	IP Grade	Picture	Item	Dimension(mm)	Drawing	Picture
C-256620-I-001	Connector	IP20		4171460-001	17x9		
C-256720-I-001	Connector	IP20		4161460-001	16x12		
C-331720-T-001	Connector	IP20		4181460-001	18x18		
C-219520-0-001	Connector	IP20		4151460-002	16x7		

## Installation Steps

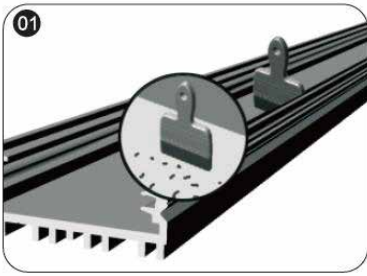

1. Making sure the installation surface is clean.

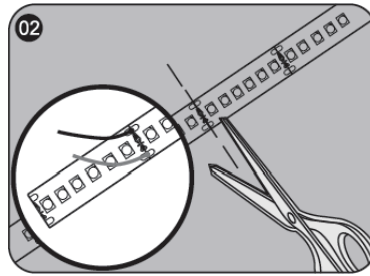

2. Measure the length of the strip light that needs to be installed, and cut off the excess strip light along the cutting line. If you need to add connecting wires, please solder at the next cut mark.

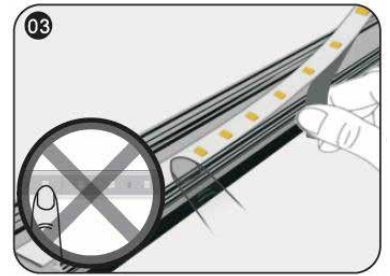

3. Please peel off the release paper on the back of strip light before sticking. it. Do not tear off all the release paper at once to prevent the strip light from sticking to each other.  
**Note: Do not press the LED.**



4. The place where the cut mark on strip light is in contact with inner bottom surface of profile are isolated by adhesive tape to avoid short circuit.

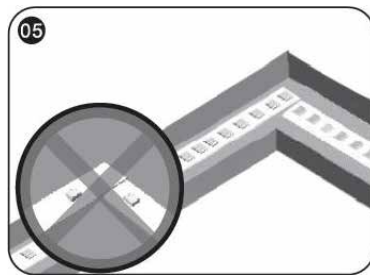

5. The installation drawing of sticking strip light to the corner.  
**Note: Do not bend strip light into right angle.**



6. After the strip light is installed, the strip light wire is connected to the power output terminal. Insulation, short-circuit prevention, and corrosion prevention measures should be taken at the terminals.

## Cautions

When install the led strip, please note the installaiton technique. The led strip can be bent, but not distorted, as shown below.

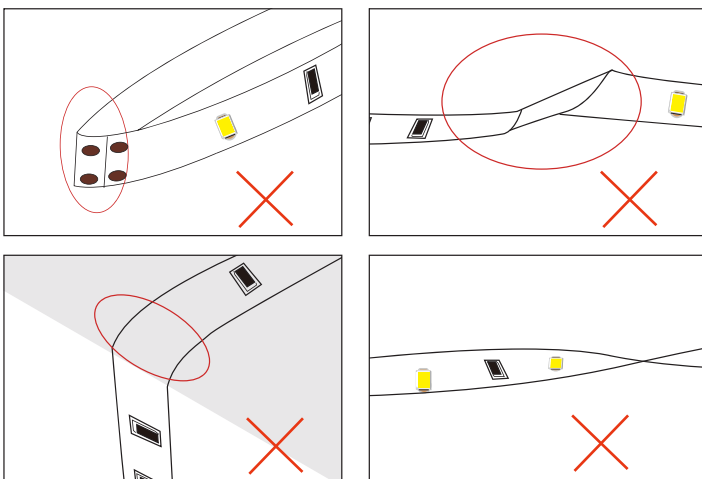

Distortion (Wrong)

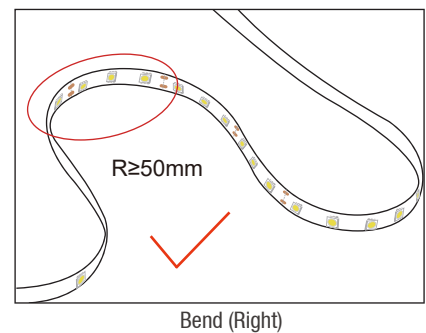

Bend (Right)

➤ LED strips are low voltage products, you must use the power supply(transformer). Please don't connect the led strip directly to the AC 110V or AC 220V, otherwise it will burn out the LED strips.

➤ Clean up the installation surface, it will ensure the reliability of the adhesive. The electrical connection process must be operated by a professional person.

## Packing information

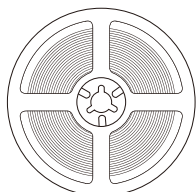

5 meters per roll

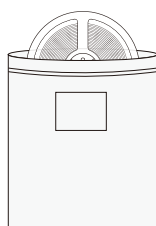

One roll per inner box

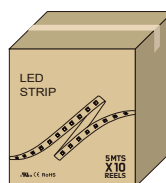

15 rolls per inner box

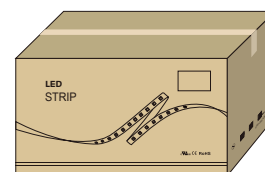

300m per carton

Part Number	Carton Dimension (mm)	Quantity per inner box (m)	Quantity Per Carton (m)	Net Weight (kg)	Gross Weight (kg)
SE120LCG-10	L495*W395*H290	75	300	9.1	11.3

Given the packing manner difference, the actual packing information is subject to that for the real products.

## Instructions

- 1) Disassembling or modifying the product is not allowed.
- 2) Installation with power on is not allowed.
- 3) Any organic solvent chemical is not allowed.
- 4) Isolation and corrosion prevention on all wiring points and wire ends.
- 5) Make sure the power wire is big enough and ensure the voltage and connection are all correct before power on.
- 6) Installation, maintenance should be done by professional staff.
- 7) 5M in a serial connection maximum for DC24V strips.
- 8) The power wire between power supply and LED strips should be less than two meters to keep the same brightness on all parts.
- 9) The maximum bending diameter of this product: 60mm.

## Declaration

- 1) To ensure the safety, the broken wires need to be replaced by the manufacturer or the service agent, or by the qualified staff.
- 2) The given data in the specification is the laboratory data, there may be discrepancy found in the actual products.
- 3) The given drawings in the specification are only for reference, there may be discrepancy found in the actual products.
- 4) The products are subject to change without prior notification.



Official Website



WeChat Public

## SHENZHEN LEADBEYOND LINEAR LIGHTING CO., LTD.

Tel: +86-755-83056231 info@leadbeyondled.com www.leadbeyondled.net www.leadbeyondled.com

Company Address.: 28F, Luban Building, Hongli West Road, Futian District, Shenzhen 518034, China

Factory Address: 3F, 4F and 6F, Buiding A&B Xinyongfeng Industrial Area, Yingrenshi Village, Shiyantown, Bao'an District, Shenzhen 518108, China