

FLEXIBLE LED WALL WASHER

Model: SF24JC3-N2523



Features

- 1) The optical lens emits light to meet different product lighting requirements.
- 2) High flexibility, bendable shape; minimum bending radius 200mm.
- 3) Weather resistance, which is an irreplaceable advantage of any other material.
- 4) Silica gel integral molding, IP65.
- 5) The flame retardant grade is as high as 94V0, the fully covered silicone material is fireproof, and has excellent high and low temperature resistance.
- 6) 3 years warranty.

Application

It is used for wall-washing lighting on building surfaces, and decorative lighting for indoor and outdoor special-shaped wall-washing.

Parameters

Part Number	SF24JC3-N2523	CRI	Color	CCT(K)	Luminous Flux (LM/M)	Efficacy (LM/W)
Dimensions	1000*25*23mm	80+	WW	● 2700	1200	50
LED Qty/m	24LEDs/m		WW	● 3000	1250	52
Voltage	DC24V		NW	● 4000	1350	55
Input Current (A)	1.0A (1m)		MW	● 5000	1350	55
Power	24W/M		W	● 6000	1450	60
IP Grade	IP65					
Beaming Angle	20×55°/10×65°/35°					
Minimum Cutting unit	123MM					
The Maximum Length	Unilateral power supply 5m(standard 1m/PCS)					
shell material	food grade silicone					
Storage Temperature	-45 ℃ to 75 ℃					
Operating Temperature	-40 ℃ to 50 ℃					
Net Weight	690g/M					

Remarks:

- 1) The given data are typical values due to the tolerance of the production and electrical components, output value and electrical power can vary up to 10%.
- 2) Testing standards refer to IES LM-79-08.
- 3) The above luminous flux is based on CRI90, and the number will reduce by around 20% in CRI 80.

Dimension

1. Conventional Side Outlet Mode

(Unit: mm)

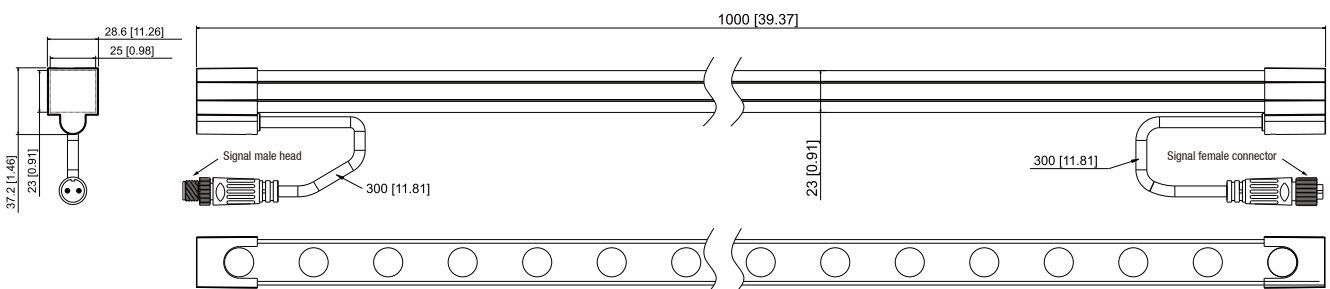

2. Integrated Bottom Outlet Mode

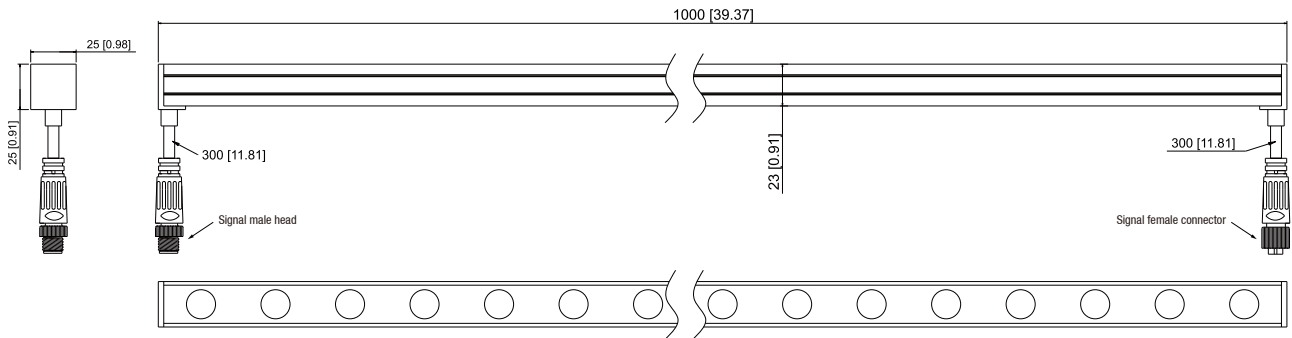

Rendering Index Comparison

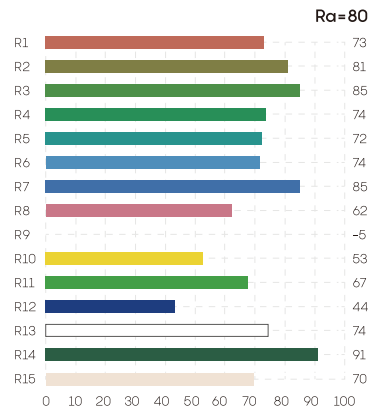
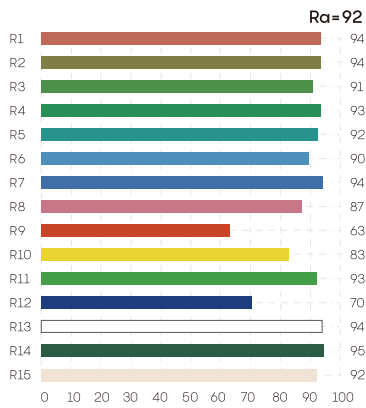

Provide Full CCT Range From 2700K to 6500K

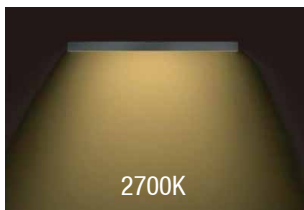

Light distribution curve

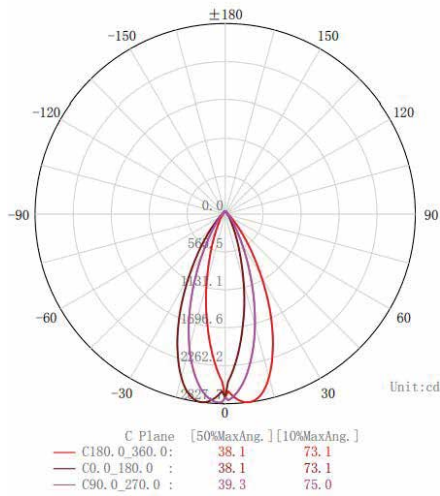

Beaming Angle 35°

Illuminance chart

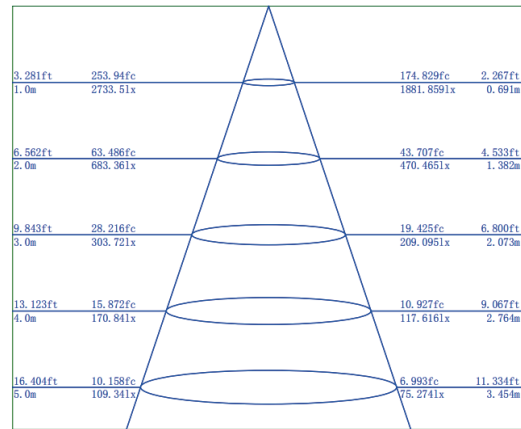

Center Height Center Irradiation Angle Average Irradiation Angle Light Spot Diameter

Note: The curve is the illumination area and the average illuminance in the area of the lamp under different projection distances.

Wire Connection

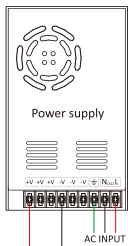

AC INPUT

Red wire is connected to the positive pole
black wire to negative pole

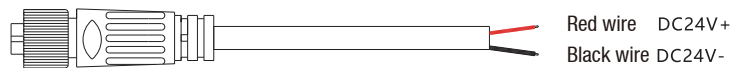

M12 waterproof female connector wiring

Max 5000mm

Connections

Connections

Minimum bending radius: Min R200

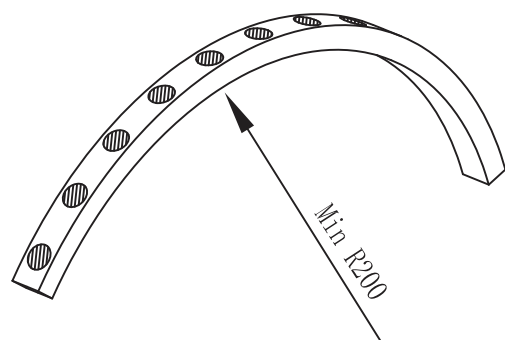
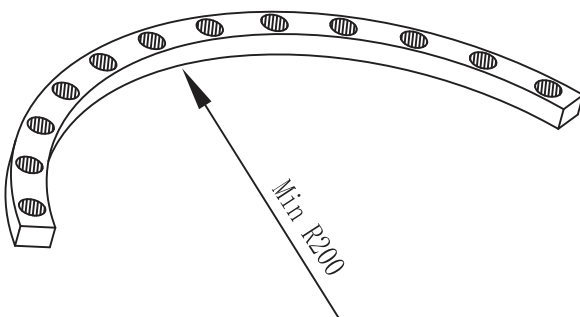

Remarks:

The bending direction of the lamp is shown in the figure above, it can be bent along the lamp surface and the back, and the minimum bending radius is 200mm.

Mounting Accessories

Install Aluminum Channel
Accessory No.: 4451460-002

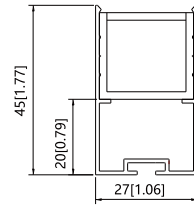
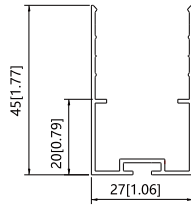
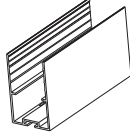

Continuous Bend Mounting Aluminum Channel
Accessory No.: 4451460-001

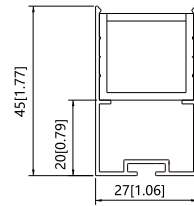
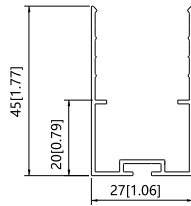
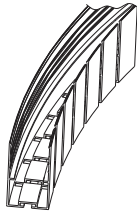

Aluminum channel with visor mounting
Accessory No.: 4771460-002

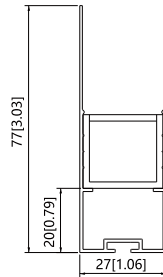
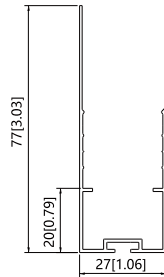
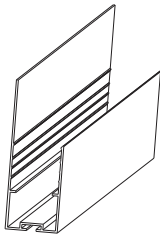

Continuously curved with visor mounted
Aluminum channel
Accessory No.: 4771460-001

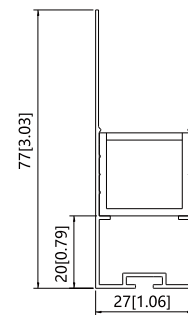
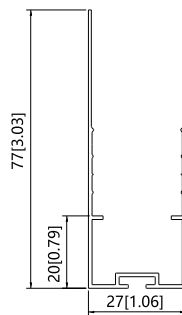
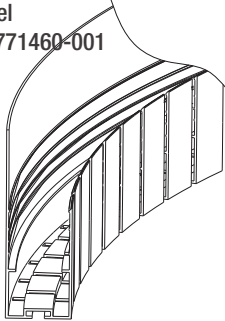

Aluminum alloy swivel bracket
Accessory No.: 4001290-001

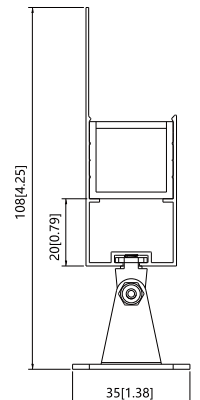
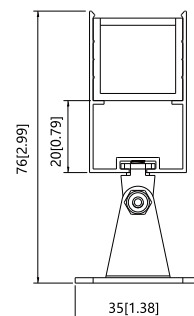
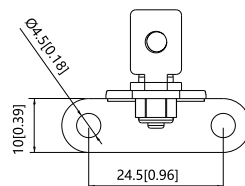
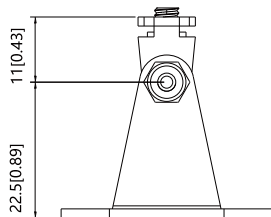
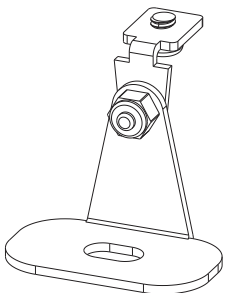

Packing Information

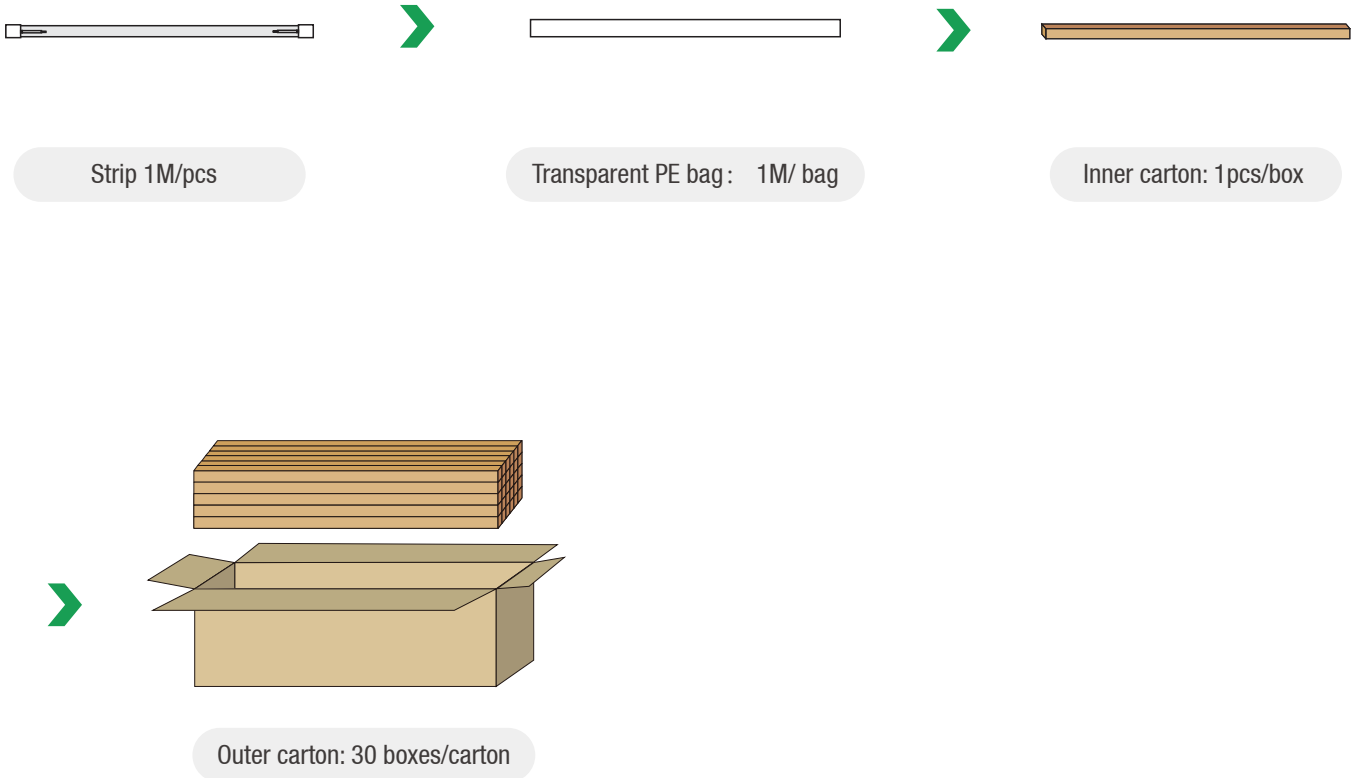

Part Number	Inner carton dimension(mm)	Outer carton dimension(mm)	Net Weight (kg)	Gross Weight (kg)
SF24JC3-N2523	1035*40*35	1050*270*205	20.7	23.6

Given the packing manner difference, the actual packing information is subject to that for the real products.

Instructions

- 01) Disassembling or modifying the product is not allowed.
- 02) Installation with power on is not allowed.
- 03) Any organic solvent chemical is not allowed.
- 04) Isolation and corrosion prevention on all wiring points and wire ends.
- 05) Make sure the power wire is big enough and ensure the voltage and connection are all correct before power on.
- 06) Installation, maintenance should be done by professional staff.
- 07) The power wire between power supply and LED strips should be less than two meters to keep the same brightness on all parts.
- 08) Do not power on during installation or assembly of the light strip, to avoid short-circuiting and burning out of the light strip due to misoperation during the operation
- 09) The lamp beads can only be powered on when they are connected, installed and correct.
- 10) When installing, try to avoid excessive bending and twisting of the light strip, so as not to damage the conductive components and cause defects.
- 11) The LED flexible light strip can only be cut at the place where the cut mark is printed on the light strip. Cutting at other places will damage the circuit circuit of the light strip and cause some lamp beads to not light up.
- 12) Only two sections of LED flexible light strips with the same specification and voltage can be connected in series, and the total length cannot exceed the maximum cascade length.
- 13) The minimum bending diameter of this product: 400mm.

Declaration

- 1) To ensure the safety, the broken wires need to be replaced by the manufacturer or the service agent, or by the qualified staff.
- 2) The given data in the specification is the laboratory data, there may be discrepancy found in the actual products.
- 3) The given drawings in the specification are only for reference, there may be discrepancy found in the actual products.
- 4) The products are subject to change without prior notification.



Official Website



WeChat Public

SHENZHEN LEADBEYOND LINEAR LIGHTING CO., LTD.

Tel: +86-755-83056231 info@leadbeyondled.com www.leadbeyondled.net www.leadbeyondled.com

Company Address.: 28F, Luban Building, Hongli West Road, Futian District, Shenzhen 518034, China

Factory Address: 3F, 4F and 6F, Buiding A&B Xinyongfeng Industrial Area, Yingrenshi Village, Shiyan Town, Bao'an District, Shenzhen 518108, China