

ADDRESSABLE RGB LED STRIPS

60 LEDs/m



Features

- 1) 5050LED Chips with breakpoint resume IC built-in, One single broken light will not affect signal transmission.
- 2) Constant current control, long life, high cost performance.
- 3) Various kinds of Protection grade: IP20, IP65,IP68 suitable for many occasions.
- 4) Equipped with a variety of accessories , it is convenient to connect the LED strips without soldering wires, and the installation is efficient and fast.
- 5) CE, RoHS, UL, TUV, BIS, CB and LM-80 certified.
- 6) 3 years warranty.

Application

Linear lighting, city lighting, landscape lighting, commercial lighting and house contour lighting, etc.

Parameters

Part Number	SH60LB1-10-Q02	Color	Wavelength	Color	Beaming Angle	Luminous Flux (LM/M)	Efficacy (LM/W)
Dimensions	5000*10mm	R	620-625	Red	$\geq 120^\circ$	43	6
LED Type	5050	G	520-525	Green	$\geq 120^\circ$	137	19
LED Qty/m	60LEDs/m	B	465-470	Blue	$\geq 120^\circ$	36	5
Voltage	DC12V						
Input Current (A)	0.6A (1m)						
Power	7.2W/M						
Power Range	6.5~7.9W						
Times of Power On and Off	>10000 Times						
IP Grade	IP20						

Remarks:

- 1) Data are only for reference. The limit of tolerance is plus or minus 10%.
- 2) Testing standards refer to IES LM-79-08.
- 3) When power is over 7W/M, the aluminum profile is necessary.

Dimension

(Unit: mm)

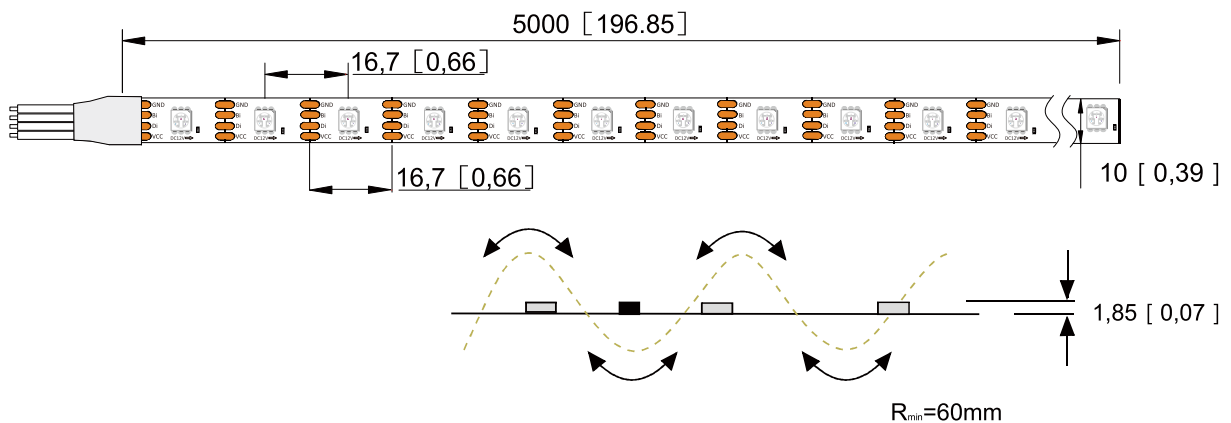



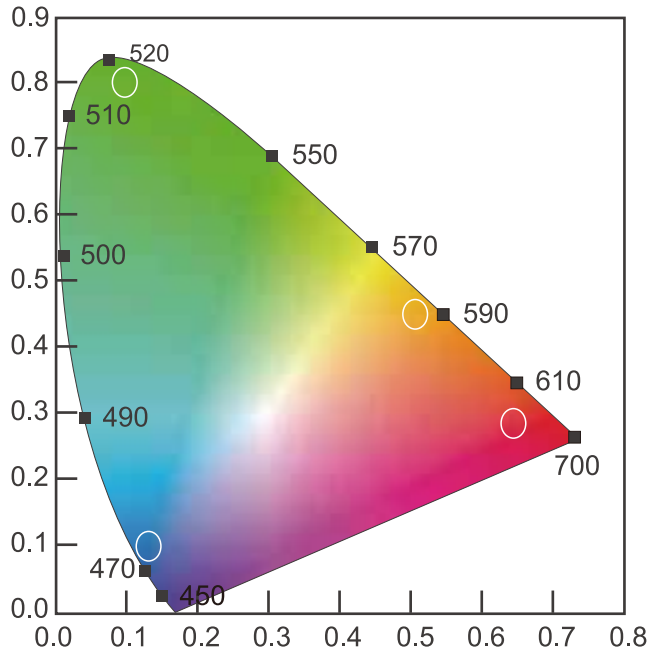

CIE Color Coordinate



Colour	Wave length
R	620-625
G	520-525
B	465-470

Provides Different IP Graded Strips

IP20	Non-waterproof		(indoor)
IP54	silicone spray		(in humid air)
IP65	silicone hollow tube		(in humid air)
IP67	silicone solid extrusion		(in rain)
IP68	PU/PVC glue hollow extrusion		(in water)

Beaming Angle

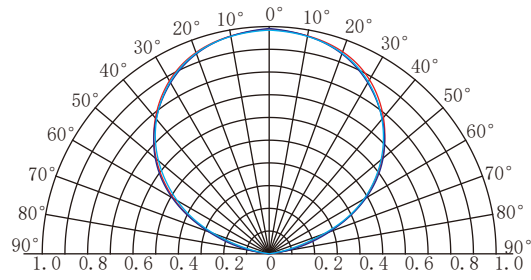

beaming angle 120°

Wire Connection

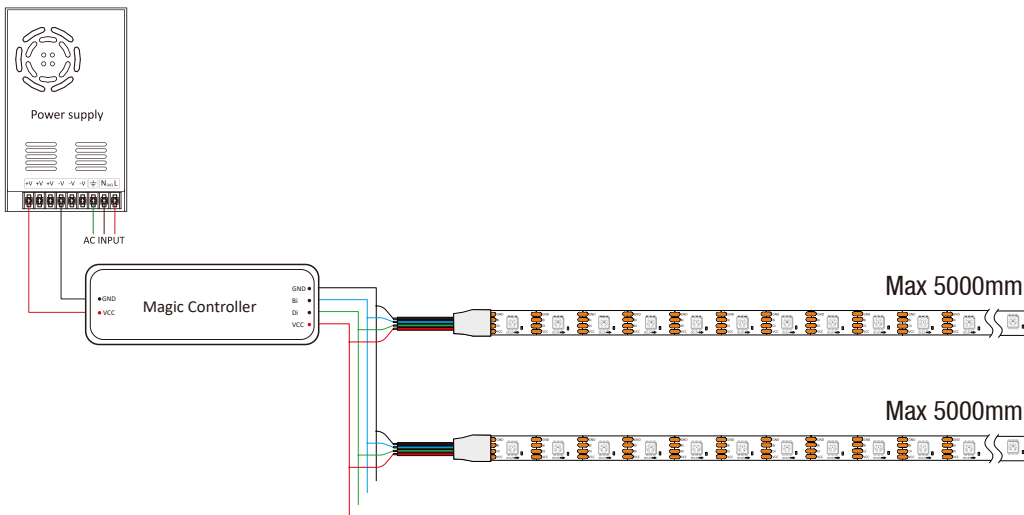

Installation Accessories

Standard Accessories				Recommended Accessories Profile			
Item	Name	IP Grade	Picture	Item	Dimension(mm)	Drawing	Picture
C-256620-I-001	Connector	IP20		4121460-001	12x8		
C-256720-I-001	Connector	IP20		4171460-001	17x9		
C-331720-T-001	Connector	IP20		4161460-001	16x12		
C-219520-0-001	Connector	IP20		4181460-001	18x18		
C-10XB20-4-004	Connector	IP20		4151460-002	16x7		

Installation Steps

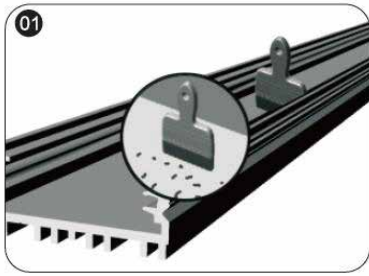

1. Making sure the installation surface is clean.

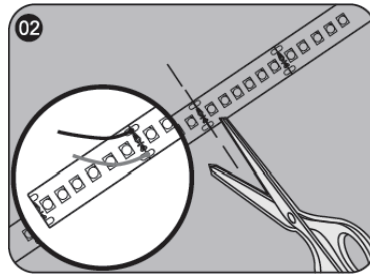

2. Measure the length of the strip light that needs to be installed, and cut off the excess strip light along the cutting line. If you need to add connecting wires, please solder at the next cut mark.

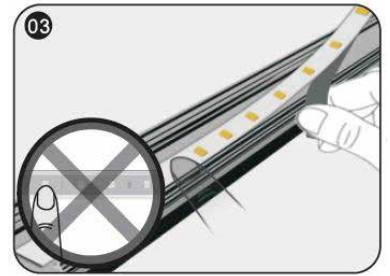

3. Please peel off the release paper on the back of strip light before sticking. it. Do not tear off all the release paper at once to prevent the strip light from sticking to each other.
Note: Do not press the LED.



4. The place where the cut mark on strip light is in contact with inner bottom surface of profile are isolated by adhesive tape to avoid short circuit.

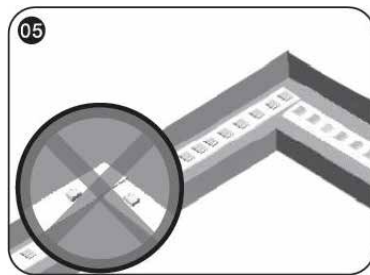

5. The installation drawing of sticking strip light to the corner.
Note: Do not bend strip light into right angle.



6. After the strip light is installed, the strip light wire is connected to the power output terminal. Insulation, short-circuit prevention, and corrosion prevention measures should be taken at the terminals.

Cautions

When install the led strip, please note the installaiton technique. The led strip can be bent, but not distorted, as shown below.

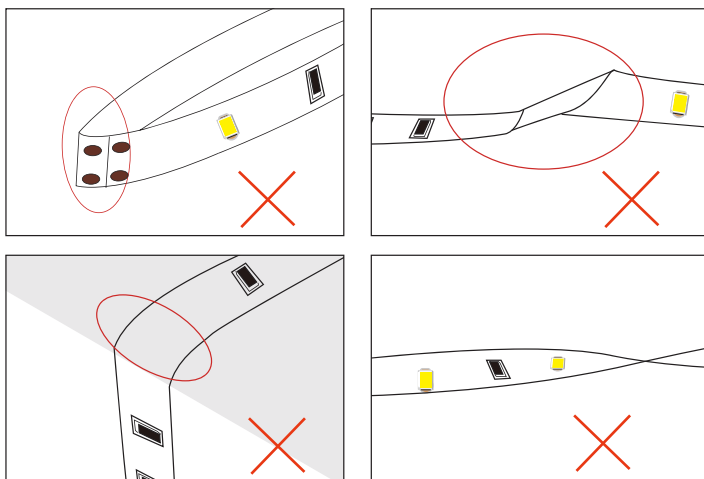

Distortion (Wrong)

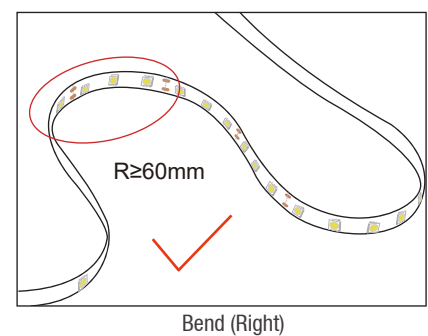

Bend (Right)

➤ LED strips are low voltage products, you must use the power supply(transformer). Please don't connect the led strip directly to the AC 110V or AC 220V, otherwise it will burn out the LED strips.

➤ Clean up the installation surface, it will ensure the reliability of the adhesive. The electrical connection process must be operated by a professional person.

Packing Information

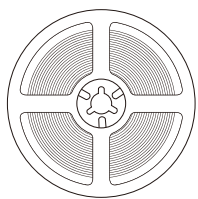

5 meters per roll

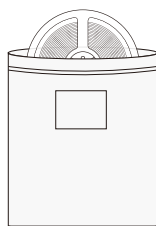

One roll per inner box

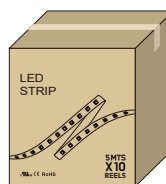

10 rolls per inner box

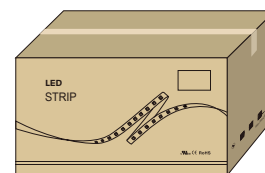

450m per carton

Part Number	Carton Dimension (mm)	Quantity per inner box (m)	Quantity Per Carton (m)	Net Weight (kg)	Gross Weight (kg)
SH60LB1-10-Q02	L495*W450*H215	50	450	7	8.7
SH60JB1-10-Q02	L495*W395*H290	50	200	15	16.7
SH60JB2-10-Q02	L495*W395*H290	50	200	15.5	17.2

Given the packing manner difference, the actual packing information is subject to that for the real products.

Instructions

- 1) Disassembling or modifying the product is not allowed.
- 2) Installation with power on is not allowed.
- 3) Any organic solvent chemical is not allowed.
- 4) Isolation and corrosion prevention on all wiring points and wire ends.
- 5) Make sure the power wire is big enough and ensure the voltage and connection are all correct before power on.
- 6) Installation, maintenance should be done by professional staff.
- 7) 5M in a serial connection maximum for DC12V strips.
- 8) The power wire between power supply and LED strips should be less than two meters to keep the same brightness on all parts.
- 9) The maximum bending diameter of this product: 60mm.

Declaration

- 1) To ensure the safety, the broken wires need to be replaced by the manufacturer or the service agent, or by the qualified staff.
- 2) The given data in the specification is the laboratory data, there may be discrepancy found in the actual products.
- 3) The given drawings in the specification are only for reference, there may be discrepancy found in the actual products.
- 4) The products are subject to change without prior notification.



Official Website



WeChat Public

SHENZHEN LEADBEYOND LINEAR LIGHTING CO., LTD.

Tel: +86-755-83056231 info@leadbeyondled.com www.leadbeyondled.net www.leadbeyondled.com

Company Address.: 28F, Luban Building, Hongli West Road, Futian District, Shenzhen 518034, China

Factory Address: 3F, 4F and 6F, Buiding A&B Xinyongfeng Industrial Area, Yingrenshi Village, Shiyan Town, Bao'an District, Shenzhen 518108, China