

# CCT ADJUSTABLE COB LED STRIP

Model : SQ608LC1-DW-24V

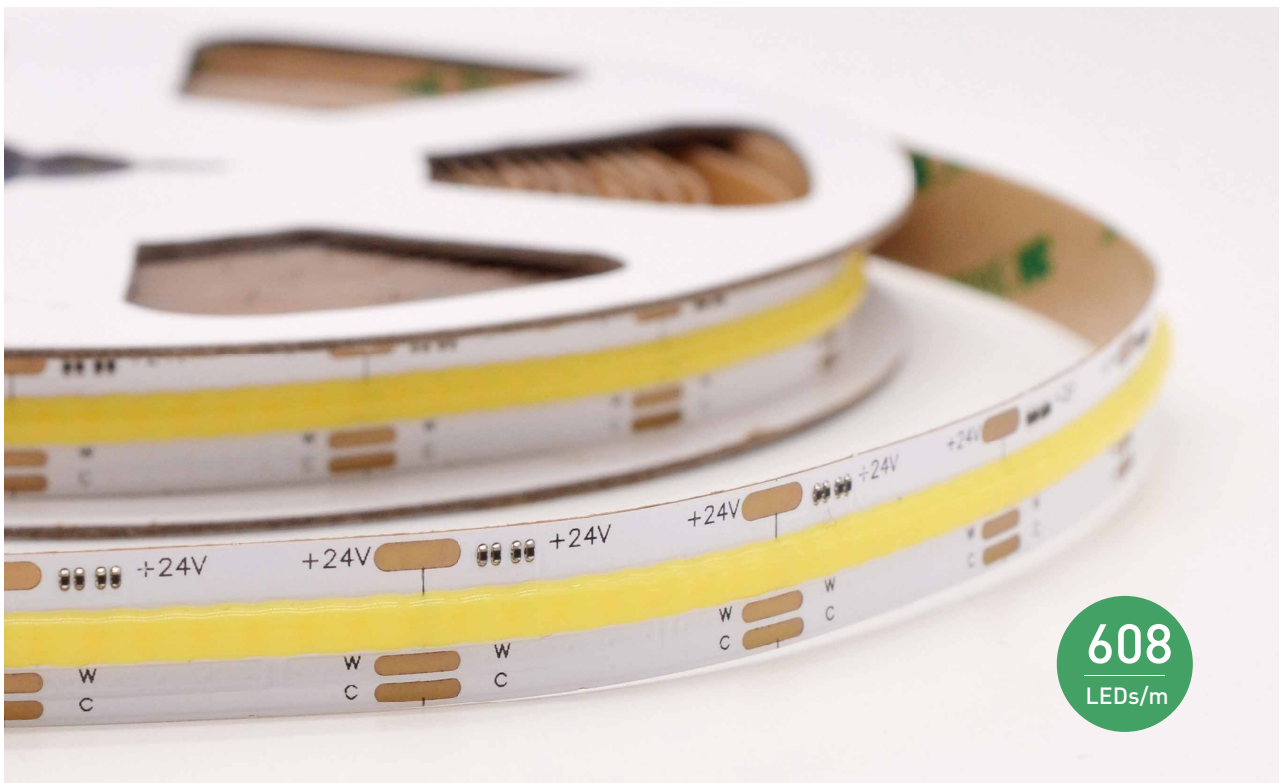



## Product Features

1. No spot, no shadow, soft light.
2. The antistatic grade (MIL – STD – 883 – e) : HBM level 2 (2000 ~ 4000 v)
3. The largest emitting angle can reach to 180°
4. Can be cut, and be free to cut off and weld along with the above cutting line.



## Structure

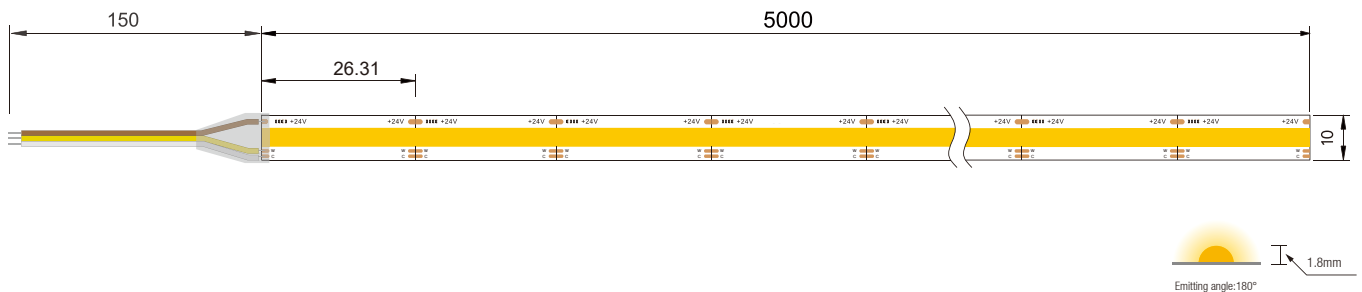

## Parameter

Model No	SQ608LC1-DW	Lifetime hour	50000h
Input voltage	DC 24V	Warranty	3years
CRI(Ra)	>90Ra	Working temperture	-20 °C ~ +45 °C
Color	WW+W	Segment	26.31mm
LED Q'ty/m	608/m	PCB Width	10mm
SMD Type	COB		

Max Power/m	Max current / unit	3000-6000K
14W	16mA	1400lm
15W	17mA	

### SHENZHEN LINGBENYANG IND. CO., LTD.

Tel: +86-755-83544570 Fax: +86-755-83056229 E-mail: info@lbyled.com Http://: www.lbyled.com

Company Address.: 28F, Luban Building, Hongli West Road, Futian District, Shenzhen 518034, China

Factory Address: 6F, Xinyongfeng Industrial Area, Yingrenshi Village, Shiyan Town, Bao'an District, Shenzhen 518108, China

 **Cautions**

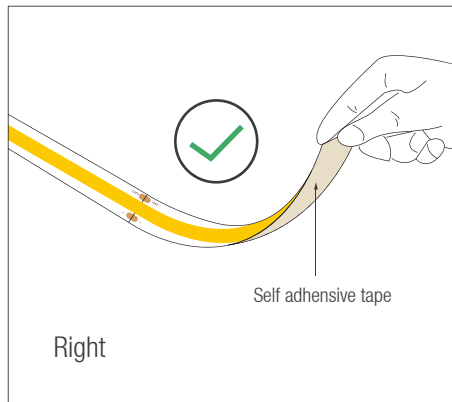
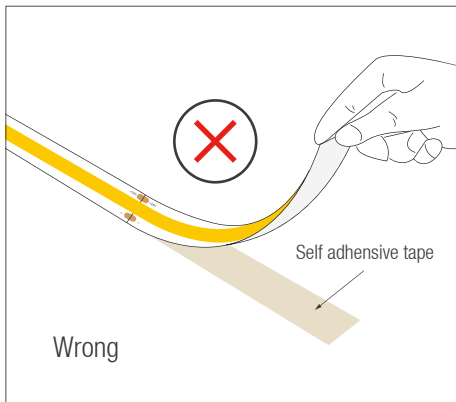

If the led strip needs to be torn up, please make sure that the self adhesive tape is torn with the led strip, otherwise the led strip will be damaged

When install the led strip, please note the installation technique. The led strip can be bent, but not distorted, as shown below.

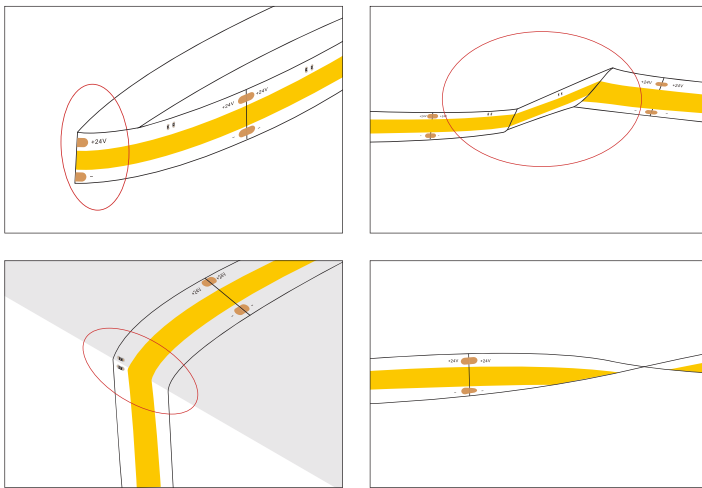

Distortion(Wrong)

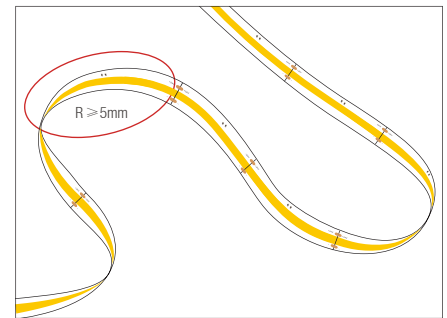

Bend(Right)

➤ LED strips are low voltage products, you must use the power supply(transformer). Please don't connect the led strip directly to the AC 110v or AC 220v, otherwise it will burn out the LED strips.

➤ Clean up the installation surface, it will ensure the reliability of the adhesive. The electrical connection process must be operated by a professional person.

## Wiring Diagram

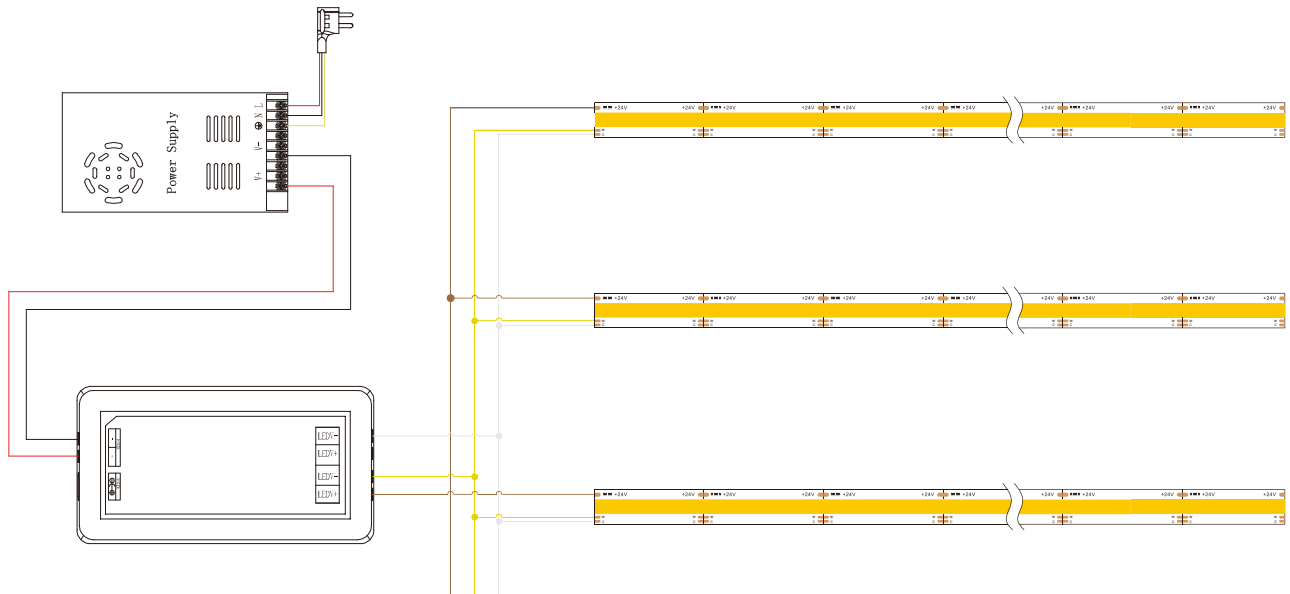

## Package

