

# DIAMOND STANDARD LED MODULES

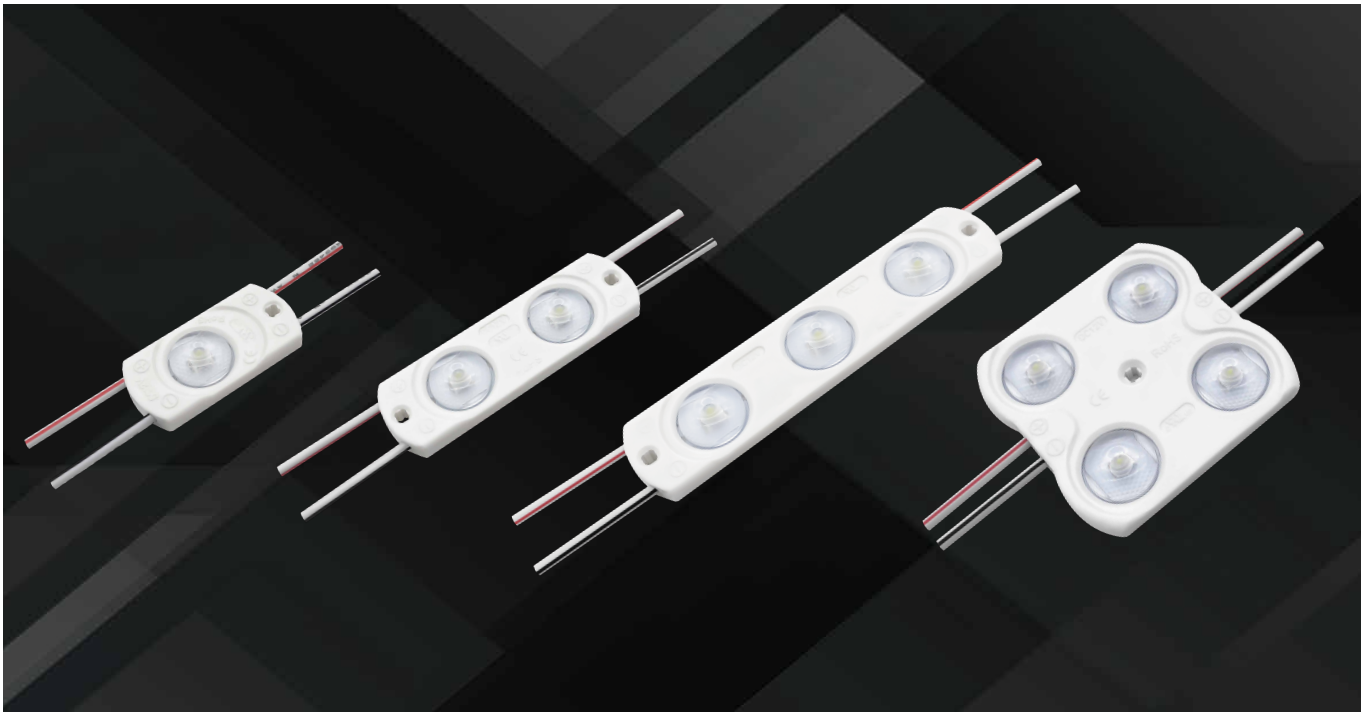

## Features

- Powered by high output 2835 LED.
- Constant current.
- Diamondback 170° optic lens.
- 50 PCS per string
- CE, RoHS,UL,TUV, BIS, CB and LM-80 certified.

## Application

- Apply to 4–15 cm depth illuminated letter or light box at airports, metros, banks, buildings and shopping malls, etc.

## Parameters

| Items              | Parameters       |                  |                  |                  |
|--------------------|------------------|------------------|------------------|------------------|
| Part Number        | ZE01BB3          | ZE02BB3          | ZE03BB3          | ZE04BB3          |
| CCT (K)            | 7000K            | 7000K            | 7000K            | 7000K            |
| Beaming Angle (°)  | 170°             | 170°             | 170°             | 170°             |
| CRI (Ra)           | ≥75              | ≥75              | ≥75              | ≥75              |
| Luminous Flux (lm) | 40               | 80               | 120              | 160              |
| Voltage (V)        | DC12             | DC12             | DC12             | DC12             |
| Power (W)          | 0.4              | 0.8              | 1.2              | 1.6              |
| Driving Method     | Constant current | Constant current | Constant current | Constant current |
| Dimension (mm)     | 36*17.5*6.2      | 56*17.5*6.2      | 80*17.5*6.2      | 45*43*6.2        |
| Working Tem. (°C)  | -25 ~ +60        | -25 ~ +60        | -25 ~ +60        | -25 ~ +60        |
| Storage Tem. (°C)  | -25 ~ +70        | -25 ~ +70        | -25 ~ +70        | -25 ~ +70        |
| Protection Grade   | IP65             | IP65             | IP65             | IP65             |

## Dimension

Unit: mm

ZE01BB3

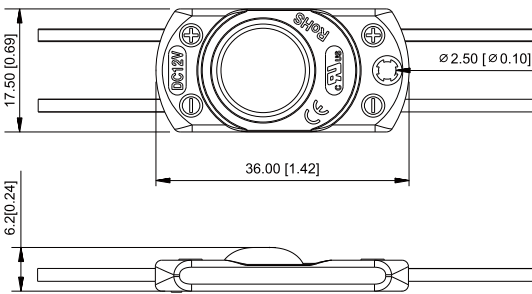

ZE02BB3

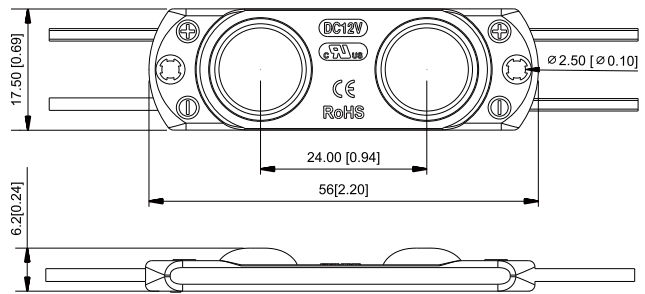

ZE03BB3

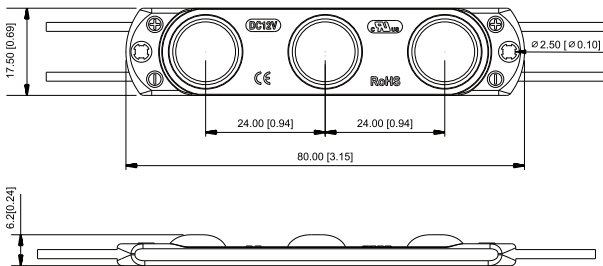

ZE04BB3

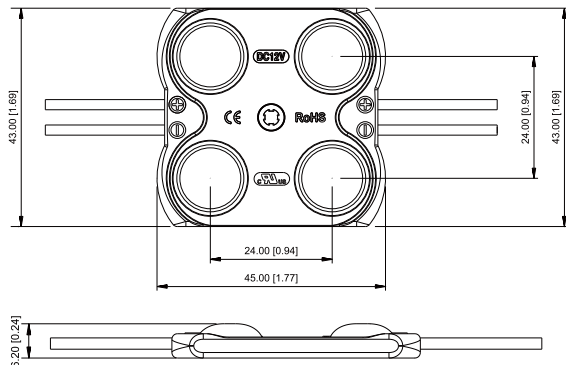

## Beaming Angle

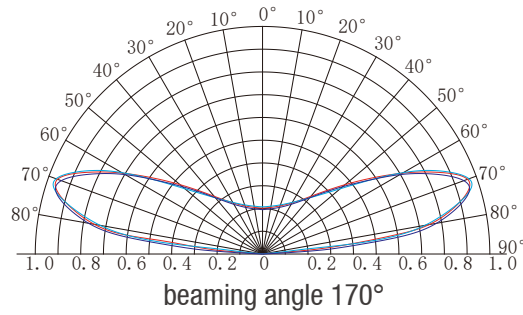

## Reference Scheme

| Part Number | Depth(mm) | Distance(mm) | Density(pcs/m <sup>2</sup> ) | Illumination(lux) |
|-------------|-----------|--------------|------------------------------|-------------------|
| ZE01BB3     | Dz=30     | Dx=60 Dy=60  | 278                          | 3200–3500         |
|             | Dz=40     | Dx=75 Dy=75  | 178                          | 2700–3000         |
|             | Dz=50     | Dx=90 Dy=90  | 123                          | 1800–2100         |
|             | Dz=60     | Dx=110 Dy=90 | 101                          | 1300–1600         |

| Part Number | Depth(mm) | Distance(mm) | Density(pcs/m <sup>2</sup> ) | Illumination(lux) |
|-------------|-----------|--------------|------------------------------|-------------------|
| ZE02BB3     | Dz=40     | Dx=90 Dy=60  | 185                          | 5300–5800         |
|             | Dz=50     | Dx=110 Dy=80 | 114                          | 2700–3000         |
|             | Dz=60     | Dx=130 Dy=90 | 85                           | 2500–2800         |
|             | Dz=80     | Dx=160 Dy=90 | 69                           | 1600–1900         |
|             | Dz=100    | Dx=160 Dy=90 | 69                           | 1400–1700         |

| Part Number | Depth(mm) | Distance(mm) | Density(pcs/m <sup>2</sup> ) | Illumination(lux) |
|-------------|-----------|--------------|------------------------------|-------------------|
| ZE03BB3     | Dz=60     | Dx=130 Dy=90 | 85                           | 4300–4700         |
|             | Dz=80     | Dx=150 Dy=90 | 74                           | 2800–3200         |
|             | Dz=100    | Dx=180 Dy=90 | 62                           | 1800–2300         |
|             | Dz=120    | Dx=180 Dy=90 | 62                           | 1300–1700         |
|             | Dz=150    | Dx=180 Dy=90 | 62                           | 1000–1300         |

| Part Number | Depth(mm) | Distance(mm)  | Density(pcs/m <sup>2</sup> ) | Illumination(lux) |
|-------------|-----------|---------------|------------------------------|-------------------|
| ZE04BB3     | Dz=80     | Dx=130 Dy=100 | 77                           | 4000–4500         |
|             | Dz=100    | Dx=150 Dy=100 | 67                           | 2500–3000         |
|             | Dz=120    | Dx=150 Dy=100 | 67                           | 2000–2400         |
|             | Dz=150    | Dx=150 Dy=100 | 67                           | 1500–1800         |
|             | Dz=180    | Dx=150 Dy=100 | 67                           | 1300–1600         |

### Remark :

- 01. The transmittance of the Acrylic was 56%.
- 02. The above data is for reference only.

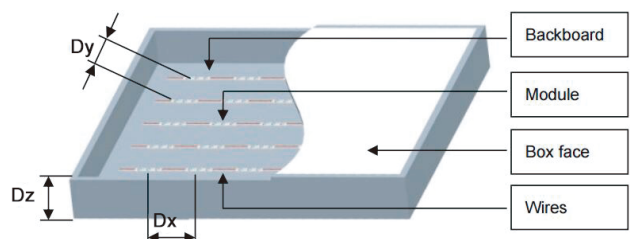

## Wire Connection

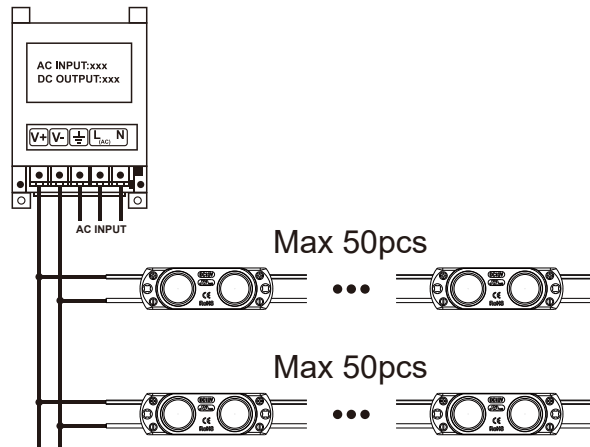

## Packing

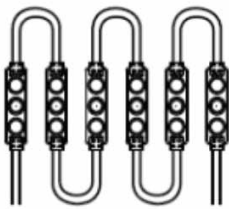

20pcs per string

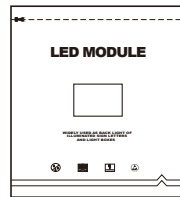

100 pcs in an anti-static bag

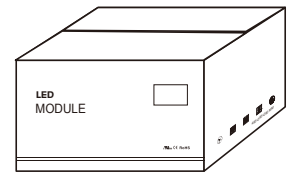

1500/1000 pcs in a carton

## Packing Specification

- Antistatic bag adopted
- Packing information

| Part Number              | ZE01BB3     | ZE02BB3     | ZE03BB3     | ZE04BB3      |
|--------------------------|-------------|-------------|-------------|--------------|
| Carton Dimension(mm)     | 490*450*220 | 490*450*220 | 490*450*220 | 490*450*220  |
| Bags Per Carton          | 15          | 10          | 10          | 10           |
| Quantity Per Carton(pcs) | 1500        | 1000        | 1000        | 1000         |
| Net Weight(kg)           | 9.2(1±10%)  | 8.3(1±10%)  | 11.2(1±10%) | 14.65(1±10%) |
| Gross Weight(kg)         | 10.3(1±10%) | 9.4(1±10%)  | 12.3(1±10%) | 15.76(1±10%) |

Due to the packing manner difference, please adhere to the original products in case of discrepancy found between the picture and actual product.

## Self-provided tools & material

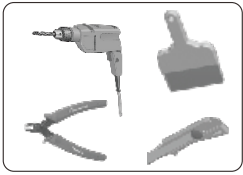

Dust brush, cutter, pencil, wire stripper, and drill

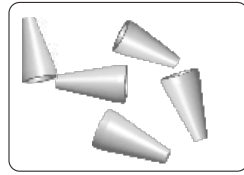

Wire Connector ( Standard)

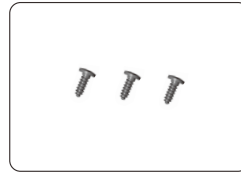

Screw

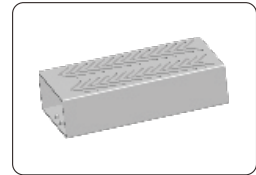

Power Supply

## Installation Guidance

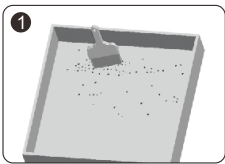

- Clean inside the light box.

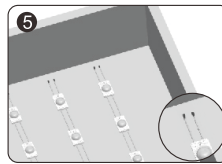

- Strip the end wire for 10mm and cap with the wire connector. Waterproof and anti-corrosion must be done on the connectors.

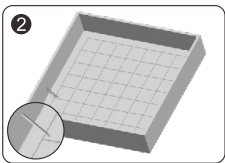

- Determine the appropriate layout.

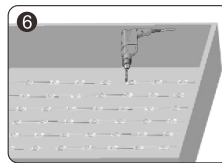

- Locate modules in the optimal position and secure with screws or neutral glass cement, which should be applied at the edge of the modules.

⚠ Note: Avoid breaking the module and wire when fixing with a drill.

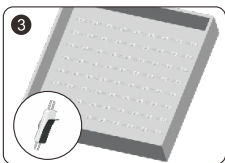

- Peel tape backing and stick modules into place.

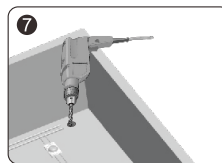

- Drill a hole for connecting power cable. Fixation and protection for the cable must be done on the hole.

⚠ Note: Avoid breaking the light box in drilling the hole.

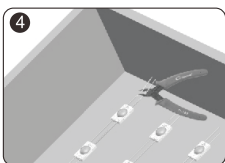

- Remove the unneeded modules.
- ⚠ Note: Cut in the middle position of the wires between modules.

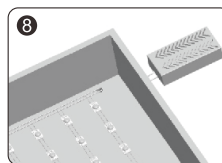

- Connect to the power cable and make sure that the polarity for connection is correct.

⚠ Note: Red wire is positive and black wire is negative.

## Instructions

01. Disassembling or modifying the product is not allowed.
02. Installation with power on is not allowed.
03. Any organic solvent chemical is not allowed.
04. Acidic or alkaline adhesive is not allowed when install, neutral glass cement could be used for installation purpose, make it drying in open environment for four hours.
05. Isolation and corrosion prevention on all wiring points and wire ends.
06. Make sure the power wire is thick enough and ensure the voltage and connections are connected correctly before power on.
07. This product should be used in a sign, do not expose it in opening site.
08. Installation, maintaining should be done by professional staff.
09. The maximum connection is 50pcs for the constant voltage version, and 50pcs for the constant current version.
10. Please do not exceed this number.
11. The power wire between power supply and module should be less than two meters to keep the same brightness on all parts.
12. Initial location with 3M tape, then secure with screws.

## Declaration

01. Warranty: 5 years.
02. In order to ensure the safety, the broken wires need to be replaced by the manufacturer or the service agent, or by the staff with the similar qualification.
03. The given data in the specification was based on the laboratory testing, there may be discrepancy found in the actual products.
04. The given drawings in the specification are only for reference, there may be discrepancy found in the actual products.
05. The products are subject to change without prior notification.



## SHENZHEN LINGBENYANG IND. CO., LTD.

Tel: +86-755-83544570      E-mail: [info@lbyled.com](mailto:info@lbyled.com)      Http://: [www.lbyled.com](http://www.lbyled.com)  
Company Address.: 28F, Luban Building, Hongli West Road, Futian District, Shenzhen 518034, China  
Factory Address: 3F, 4F and 6F, Buiding A&B Xinyongfeng Industrial Area, Yingrenshi Village,  
Shiyan Town, Bao'an District, Shenzhen 518108, China